

Klemmhalter, Innenbearbeitung, Quadratschaft

90 Grad gekrüpfte Ausführung.

Toolholder, Internal Applications, Square Shank

90 degree cranked style.

Anzugsmoment (Schraube) // Tightening torque (screw)

7,0 Nm

Bitte Hinweise im Anhang beachten // Please read add. notes

MASTER (Seite/Page 137)



Legende
Legend **139**

Scan
QR-Code

Oder besuchen Sie // Or Visit
www.simtek.info/cp/1026

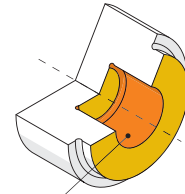
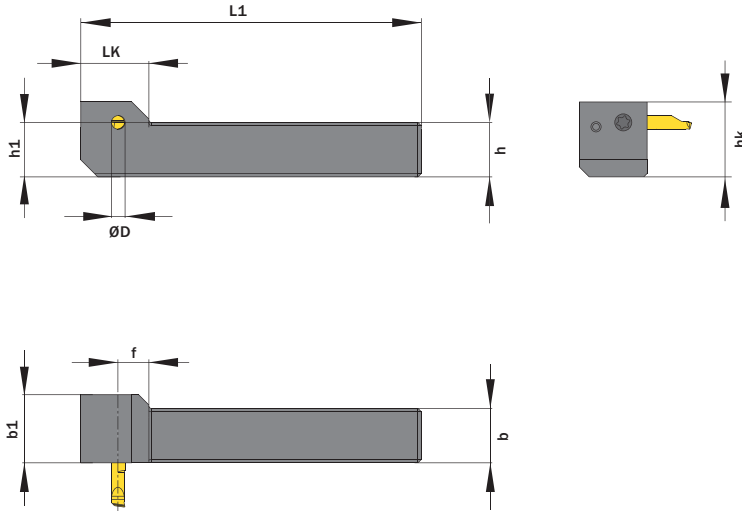

- Hauptsächlich geeignet für diese Flächen
Mainly designed for these surfaces
- Je nach Schneidplatte ebenfalls möglich
Also possible depending on insert type

Abbildung zeigt / Drawing shows: A04.1616.G.100 R

| ØD | h | b | L1 | Artikelnummer Part number | Webcode www.simtek.com/webcode | b1 | f | hk | h1 | LK | Schraube Screw | Schraubenschlüssel Screw driver | Connectcode www.simtek.com/code |
|---------------|--------|--------|-------|------------------------------|-----------------------------------|------|-----|------|------|------|-------------------|------------------------------------|--|
| mm | mm | mm | mm | | | mm | mm | mm | mm | mm | | | |
| ▼ ØD = 4,0 mm | | | | | | | | | | | | | |
| 4,0 | 12,0 | 12,0 | 80,0 | A04.1212.G.080 R/L | R AW2V L AW2U | 20,0 | 9,0 | 18,0 | 12,0 | 20,0 | AM6x7,5 T15F | T15F | R A04.R A04C.R L A04.L A04C.L |
| 4,0 | 16,0 | 16,0 | 100,0 | A04.1616.G.100 R/L | R AW4E L AW2W | 20,0 | 9,0 | 22,0 | 16,0 | 20,0 | AM6x7,5 T15F | T15F | R A04.R A04C.R L A04.L A04C.L |
| ▼ ØD = 5,0 mm | | | | | | | | | | | | | |
| 5,0 | 12,7 | 12,7 | 80,0 | A05.0.500.G.080 R | A5AV | 25,0 | 9,0 | 18,0 | 12,7 | 20,0 | AM6x7,5 T15F | T15F | A05.R <small>new inch</small> |
| 5,0 | 15,875 | 15,875 | 100,0 | A05.0.625.G.100 R | A5AX | 25,0 | 9,0 | 22,0 | 15,9 | 20,0 | AM6x7,5 T15F | T15F | A05.R <small>new inch</small> |
| 5,0 | 12,0 | 12,0 | 80,0 | A05.1212.G.080 R/L | R AW2Y L AW2X | 25,0 | 9,0 | 18,0 | 12,0 | 20,0 | AM6x7,5 T15F | T15F | R A05.R L A05.L |
| 5,0 | 16,0 | 16,0 | 100,0 | A05.1616.G.100 R/L | R AW2Ø L AW2Z | 25,0 | 9,0 | 22,0 | 16,0 | 20,0 | AM6x7,5 T15F | T15F | R A05.R L A05.L |
| ▼ ØD = 6,0 mm | | | | | | | | | | | | | |
| 6,0 | 12,0 | 12,0 | 80,0 | A06.1212.G.080 R/L | R AW22 L AW21 | 25,0 | 9,0 | 18,0 | 12,0 | 20,0 | AM6x7,5 T15F | T15F | R A06.R L A06.L |
| 6,0 | 16,0 | 16,0 | 100,0 | A06.1616.G.100 R/L | R AW24 L AW23 | 25,0 | 9,0 | 22,0 | 16,0 | 20,0 | AM6x7,5 T15F | T15F | R A06.R L A06.L |
| ▼ ØD = 7,0 mm | | | | | | | | | | | | | |
| 7,0 | 12,0 | 12,0 | 80,0 | A07.1212.G.080 R/L | R AW26 L AW25 | 25,0 | 9,0 | 18,0 | 12,0 | 20,0 | AM6x7,5 T15F | T15F | R A07.R L A07.L |
| 7,0 | 16,0 | 16,0 | 100,0 | A07.1616.G.100 R/L | R AW28 L AW27 | 25,0 | 9,0 | 22,0 | 16,0 | 20,0 | AM6x7,5 T15F | T15F | R A07.R L A07.L |

Bestellbeispiel // Order example: **A04.1616.G.100 R** (R = Rechte Ausführung // Right hand version)