

Klemmhalter, Innenbearbeitung

Schwingungsgedämpfter Hartmetall-Rundschaft mit innerer Kühlmittelzufuhr.

Toolholder, For Internal Applications

Anti-vibration solid carbide round shank toolholder with through coolant.

Anzugsmoment (Schraube) // Tightening torque (screw)

7,0 Nm

Bitte Hinweise im Anhang beachten // Please read add. notes

MASTER (Seite/Page 212)



Legende
Legend **213**



Scan
QR-Code

Oder besuchen Sie // Or Visit
www.simtek.info/cp/980

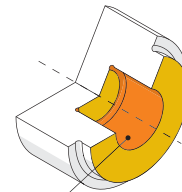
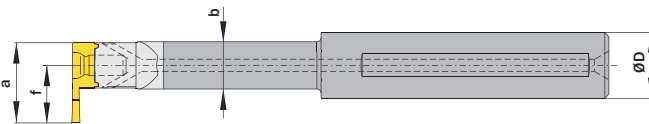
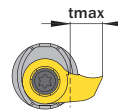
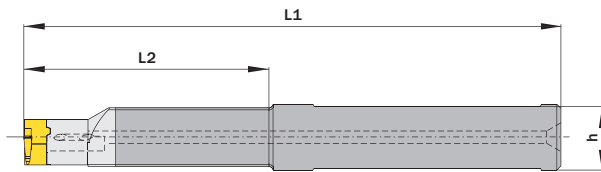

Maße „a“, „f“ und „tmax“ sind abhängig vom verwendeten Schneideinsatz.
Dimensions „a“, „f“ and „tmax“ depend on used carbide inserts.

- Hauptsächlich geeignet für diese Flächen
Mainly designed for these surfaces
- Je nach Schneidplatte ebenfalls möglich
Also possible depending on insert type

Abbildung zeigt / Drawing shows: D18.0016.60 HM

ØD ^{h6}	L2	Artikelnummer Part number	Webcode www.simtek.com/webcode	b	h	L1	Schraube Screw	Schraubenschlüssel Screw driver	Connectcode www.simtek.com/code
mm	mm			mm	mm	mm			

Fortgesetzte Tabelle
Continued Table

Verwandte Werkzeuge finden Sie auch auf der vorhergehenden Seite!
Related items can be found on the previous page as well!

▼ ØD = 15,875 mm

15,875	42,0	D18.0.625.42 HM	AVW3	11,5	14,88	100,0	D M5x12 T20T	T20T	D18	Inch
15,875	60,0	D18.0.625.60 HM	AVW4	11,5	14,88	130,0	D M5x12 T20T	T20T	D18	Inch
15,875	85,0	D18.0.625.85 HM	AVW5	11,5	14,88	160,0	D M5x12 T20T	T20T	D18	Inch

▼ ØD = 16,0 mm

16,0	42,0	D18.0016.42 HM	AEP1	11,5	15,0	100,0	D M5x12 T20T	T20T	D18
16,0	60,0	D18.0016.60 HM	AJFC	11,5	15,0	130,0	D M5x12 T20T	T20T	D18
16,0	85,0	D18.0016.85 HM	AF5G	11,5	15,0	160,0	D M5x12 T20T	T20T	D18

▼ ØD = 19,05 mm

19,05	85,0	D18.0.750.85 HM	AVW6	11,5	18,08	160,0	D M5x12 T20T	T20T	D18	Inch
-------	------	------------------------	------	------	-------	-------	--------------	------	-----	------

▼ ØD = 20,0 mm

20,0	85,0	D18.0020.85 HM	AG1A	11,5	19,0	160,0	D M5x12 T20T	T20T	D18
------	------	-----------------------	------	------	------	-------	--------------	------	-----

Bestellbeispiel // Order example: **D18.0016.42 HM**