

Klemmhalter, Axialbearbeitung

Stahl-Quadratschaft für Axialbearbeitungen, abgesetzte Version.

Toolholder, Face Grooving Applications

Steel square shank toolholder, with offset, for face grooving applications.

Anzugsmoment (Schraube) // Tightening torque (screw)

"D M4x12 T15F": 4,5 Nm
"D M5x12 T20T": 7,0 Nm

Bitte Hinweise im Anhang beachten // Please read add. notes

MASTER (Seite/Page 212)



TW Legende
ST Legend
213

Scan QR-Code Oder besuchen Sie // Or Visit
www.simtek.info/cp/806

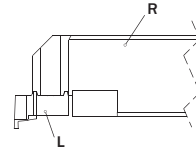
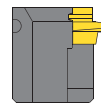
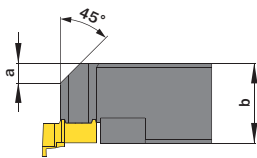
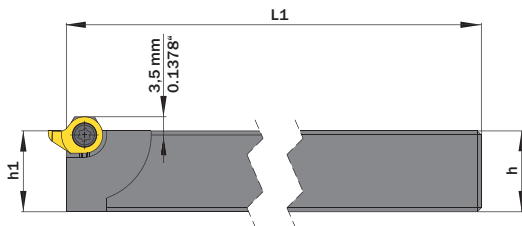

Bitte beachten: Rechter Halter wird mit linker Platte bestückt und umgekehrt.
Please use right hand toolholder with left hand insert and vice versa.

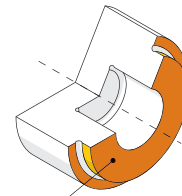

- Hauptsächlich geeignet für diese Flächen
Mainly designed for these surfaces
- Je nach Schneidplatte ebenfalls möglich
Also possible depending on insert type

Abbildung zeigt / Drawing shows: D14.2020.B.120 ST R

| h | b | Artikelnummer Part number | Webcode www.simtek.com/webcode | a | h1 ^{js14} | L1 | Schraube Screw | Schraubenschlüssel Screw driver | Connectcode www.simtek.com/ccode |
|---|-------|------------------------------|-----------------------------------|-----|--------------------|-------|-------------------|------------------------------------|--|
| mm | mm | | | mm | mm | mm | | | |
| ▼ Connectcode = D14.A.L / D14.A.R | | | | | | | | | |
| 12,0 | 12,0 | D14.1212.B.100 ST R/L | R ASEY L ASEY | 4,0 | 12,0 | 100,0 | D M4x12 T15F | T15F R | D14.A.L L D14.A.R |
| 12,7 | 12,7 | D14.0.500.S.B.100 ST R/L | R AS38 L AS34 | 4,0 | 12,7 | 100,0 | D M4x12 T15F | T15F R | D14.A.L L D14.A.R inch |
| 15,875 | 15,88 | D14.0.625.S.B.120 ST R/L | R AS39 L AS35 | 5,0 | 15,88 | 120,0 | D M4x12 T15F | T15F R | D14.A.L L D14.A.R inch |
| 16,0 | 16,0 | D14.1616.B.120 ST R/L | R ASEU L ASET | 5,0 | 16,0 | 120,0 | D M4x12 T15F | T15F R | D14.A.L L D14.A.R |
| 19,05 | 19,05 | D14.0.750.S.B.120 ST R/L | R AS4A L AS36 | 5,0 | 19,05 | 120,0 | D M4x12 T15F | T15F R | D14.A.L L D14.A.R inch |
| 20,0 | 20,0 | D14.2020.B.120 ST R/L | R ASES L ASEQ | 5,0 | 20,0 | 120,0 | D M4x12 T15F | T15F R | D14.A.L L D14.A.R |
| 25,0 | 25,0 | D14.2525.B.150 ST R/L | R ASEN L ASEP | 9,0 | 25,0 | 150,0 | D M4x12 T15F | T15F R | D14.A.L L D14.A.R |
| 25,4 | 25,4 | D14.1.000.S.B.150 ST R/L | R AS4B L AS37 | 9,0 | 25,4 | 150,0 | D M4x12 T15F | T15F R | D14.A.L L D14.A.R inch |
| ▼ Connectcode = D18.16.A.L / D18.18.A.L / D18.16.A.R / D18.18.A.R | | | | | | | | | |
| 19,05 | 19,05 | D18.0.750.B.120 ST R/L | R ASUT L ASUQ | 5,0 | 19,05 | 120,0 | D M5x12 T20T | T20T R | D18.16.A.L L D18.16.A.R D18.18.A.L L D18.18.A.R new inch |
| 20,0 | 20,0 | D18.2020.B.120 ST R/L | R AVS1 L AT9Y | 5,0 | 20,0 | 120,0 | D M5x12 T20T | T20T R | D18.16.A.L L D18.16.A.R D18.18.A.L L D18.18.A.R |
| 25,0 | 25,0 | D18.2525.B.120 ST R/L | R AWDH L AVF0 | 9,0 | 25,0 | 120,0 | D M5x12 T20T | T20T R | D18.16.A.L L D18.16.A.R D18.18.A.L L D18.18.A.R |
| 25,4 | 25,4 | D18.1.000.B.120 ST R/L | R ASUX L ASUV | 9,0 | 25,4 | 120,0 | D M5x12 T20T | T20T R | D18.16.A.L L D18.16.A.R D18.18.A.L L D18.18.A.R new inch |

Bestellbeispiel // Order example: D14.2020.B.120 ST R (R = Rechte Ausführung // Right hand version)