

Klemmhalter, Innenbearbeitung

Stahl-Rundschaft mit innerer Kühlmittelzufuhr.

Toolholder, For Internal Applications

Steel round shank toolholder with through coolant.

Anzugsmoment (Schraube) // Tightening torque (screw)

- "D M2,6x8 T8F": 1,5 Nm
- "D M2x7,5 T7F": 0,8 Nm
- "D M3x9 T9F": 2,1 Nm
- "D M4x12 T15F": 4,5 Nm
- "D M5x12 T20T": 7,0 Nm

Bitte Hinweise im Anhang beachten // Please read add. notes

MASTER (Seite/Page 212)



Legende
Legend **213**

Scan
QR-Code

Oder besuchen Sie // Or Visit
www.simtek.info/cp/812

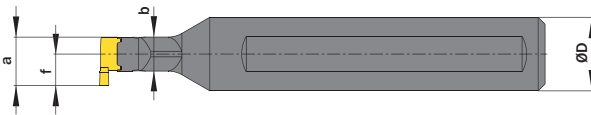
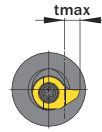
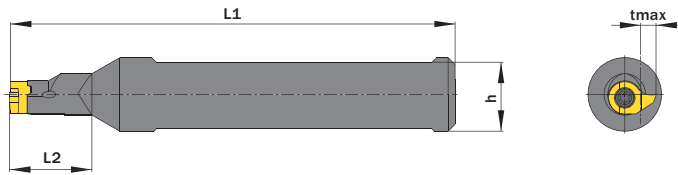

Maße „a“, „f“ und „tmax“ sind abhängig vom verwendeten Schneideinsatz.
Dimensions „a“, „f“ and „tmax“ depend on used carbide inserts.

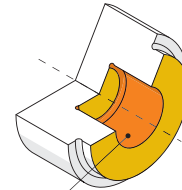

- Hauptsächlich geeignet für diese Flächen
Mainly designed for these surfaces
- Je nach Schneidplatte ebenfalls möglich
Also possible depending on insert type

Abbildung zeigt / Drawing shows: D10.0016.16 ST

| ØD ^{g6} | L2 | Artikelnummer Part number | Webcode www.simtek.com/webcode | b | h | L1 | Schraube Screw | Schraubenschlüssel Screw driver | Connectcode www.simtek.com/code |
|----------------------------|------|------------------------------|---|-------|-------|-------|-------------------|------------------------------------|---|
| mm | mm | | | mm | mm | mm | | | |
| ▼ Connectcode = D07 | | | | | | | | | |
| 12,0 | 21,0 | D07.0012.21 ST | AU5Z | 4,8 | 11,0 | 80,0 | D M2x7,5 T7F | T7F | D07 |
| 16,0 | 12,0 | D07.0016.12 ST | AU6A | 4,8 | 15,0 | 80,0 | D M2x7,5 T7F | T7F | D07 |
| 12,7 | 21,0 | D07.0.500.21 ST | A5T9 | 4,8 | 11,7 | 80,0 | D M2x7,5 T7F | T7F | D07 <small>new inch</small> |
| 15,875 | 12,0 | D07.0.625.12 ST | A5UB | 4,8 | 14,88 | 80,0 | D M2x7,5 T7F | T7F | D07 <small>new inch</small> |
| ▼ Connectcode = D09 | | | | | | | | | |
| 16,0 | 14,0 | D09.0016.14 ST | AWFE | 6,6 | 15,0 | 95,0 | D M2,6x8 T8F | T8F | D09 |
| 15,875 | 14,0 | D09.0.625.14 ST | A3UH | 6,6 | 14,88 | 95,0 | D M2,6x8 T8F | T8F | D09 <small>new inch</small> |
| ▼ Connectcode = D10 | | | | | | | | | |
| 16,0 | 16,0 | D10.0016.16 ST | ACCJ | 7,4 | 15,0 | 97,0 | D M3x9 T9F | T9F | D10 |
| 16,0 | 24,0 | D10.0016.24 ST | A016 | 7,4 | 15,0 | 97,0 | D M3x9 T9F | T9F | D10 |
| 15,875 | 16,0 | D10.0.625.16 ST | ABKU | 7,4 | 14,88 | 97,0 | D M3x9 T9F | T9F | D10 <small>inch</small> |
| 15,875 | 24,0 | D10.0.625.24 ST | A017 | 7,4 | 14,88 | 105,0 | D M3x9 T9F | T9F | D10 <small>inch</small> |
| ▼ Connectcode = D14 | | | | | | | | | |
| 16,0 | 20,0 | D14.0016.20 ST | ANP6 | 9,5 | 15,0 | 100,0 | D M4x12 T15F | T15F | D14 |
| 16,0 | 30,0 | D14.0016.30 ST | A005 | 9,5 | 15,0 | 100,0 | D M4x12 T15F | T15F | D14 |
| 15,875 | 20,0 | D14.0.625.20 ST | ADZ8 | 9,5 | 14,88 | 100,0 | D M4x12 T15F | T15F | D14 <small>inch</small> |
| 15,875 | 30,0 | D14.0.625.30 ST | A5UD | 9,5 | 14,88 | 100,0 | D M4x12 T15F | T15F | D14 <small>new inch</small> |
| ▼ Connectcode = D18 | | | | | | | | | |
| 20,0 | 25,0 | D18.0020.25 ST | AAWH | 11,5 | 19,0 | 95,0 | D M5x12 T20T | T20T | D18 |
| 20,0 | 40,0 | D18.0020.40 ST | APH3 | 11,5 | 19,0 | 105,0 | D M5x12 T20T | T20T | D18 |
| 19,05 | 25,0 | D18.0.750.25 ST | AVW1 | 11,48 | 18,05 | 95,0 | D M5x12 T20T | T20T | D18 <small>inch</small> |
| 19,05 | 40,0 | D18.0.750.40 ST | AVW2 | 11,48 | 18,05 | 105,0 | D M5x12 T20T | T20T | D18 <small>inch</small> |

Bestellbeispiel // Order example: **D14.0016.20 ST**