

Klemmhalter, Innenbearbeitung, Quadratschaft

Quadratischer Schaft für die Innenbearbeitung.

Toolholder, Internal Applications, Square Shank

Square shank for internal applications.

Anzugsmoment (Schraube) // Tightening torque (screw)

7,0 Nm

Bitte Hinweise im Anhang beachten // Please read add. notes

MASTER (Seite/Page 137)



TW Legende
ST Legend

139



Scan QR-Code

Oder besuchen Sie // Or Visit
www.simtek.info/cp/1062

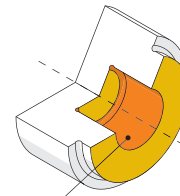
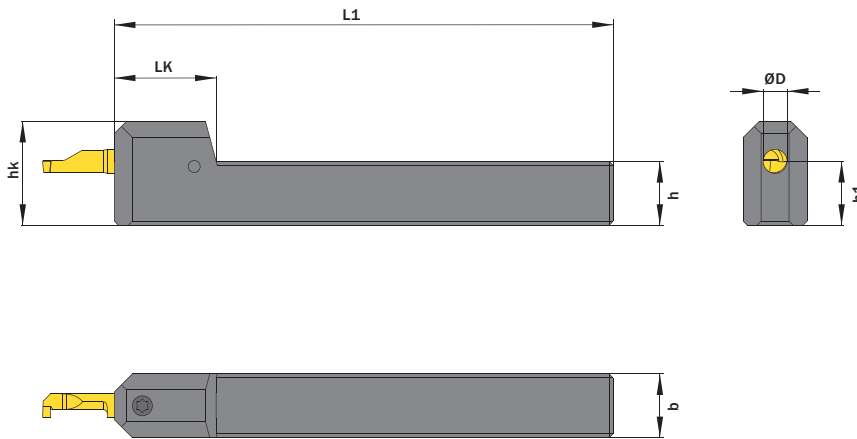

- Hauptsächlich geeignet für diese Flächen
Mainly designed for these surfaces
- Je nach Schneidplatte ebenfalls möglich
Also possible depending on insert type

Abbildung zeigt / Drawing shows: A06.1616

| ØD | h | b | Artikelnummer Part number | Webcode www.simtek.com/webcode | h1 | hk | L1 | LK | Schraube Screw | Schraubenschlüssel Screw driver | Connectcode www.simtek.com/ccode |
|----|----|----|------------------------------|-----------------------------------|----|----|----|----|-------------------|------------------------------------|-------------------------------------|
| mm | mm | mm | | | mm | mm | mm | mm | | | |

Fortgesetzte Tabelle
Continued Table

Verwandte Werkzeuge finden Sie auch auf der vorhergehenden Seite!
Related items can be found on the previous page as well!

▼ ØD = 8,0 mm

| | | | | | | | | | | | | |
|-----|--------|--------|--------------------|------|-------|------|-------|------|---------------|------|----------|------|
| 8,0 | 15,875 | 15,875 | A08.0.625.S | AFE2 | 15,88 | 27,0 | 125,0 | 32,5 | A M6x7,5 T15F | T15F | A08 A08T | Inch |
| 8,0 | 19,05 | 19,05 | A08.0.750.S | AKVD | 19,05 | 30,0 | 125,0 | 32,5 | A M6x7,5 T15F | T15F | A08 A08T | Inch |
| 8,0 | 25,4 | 25,4 | A08.1.000.S | AT9T | 25,4 | 36,0 | 150,0 | 32,5 | A M6x7,5 T15F | T15F | A08 A08T | Inch |
| 8,0 | 16,0 | 16,0 | A08.1616 | AGKM | 16,0 | 27,0 | 125,0 | 32,5 | A M6x7,5 T15F | T15F | A08 A08T | |
| 8,0 | 20,0 | 20,0 | A08.2020 | ABBG | 20,0 | 31,0 | 125,0 | 32,5 | A M6x7,5 T15F | T15F | A08 A08T | |
| 8,0 | 25,0 | 25,0 | A08.2525 | AT9P | 25,0 | 36,0 | 150,0 | 32,5 | A M6x7,5 T15F | T15F | A08 A08T | |

▼ ØD = 10,0 mm

| | | | | | | | | | | | | |
|------|-------|-------|--------------------|------|-------|------|-------|------|---------------|------|------------------|------|
| 10,0 | 19,05 | 19,05 | A10.0.750.S | ANCN | 19,05 | 31,0 | 125,0 | 34,5 | A M6x7,5 T15F | T15F | A10.L A10.R A10T | Inch |
| 10,0 | 25,4 | 25,4 | A10.1.000.S | AT9U | 25,4 | 37,0 | 150,0 | 34,5 | A M6x7,5 T15F | T15F | A10.L A10.R A10T | Inch |
| 10,0 | 20,0 | 20,0 | A10.2020 | APC9 | 20,0 | 32,0 | 125,0 | 34,5 | A M6x7,5 T15F | T15F | A10.L A10.R A10T | |
| 10,0 | 25,0 | 25,0 | A10.2525 | AT9Q | 25,0 | 37,0 | 150,0 | 34,5 | A M6x7,5 T15F | T15F | A10.L A10.R A10T | |

Bestellbeispiel // Order example: **A10.2020**