

Doppelklemmhalter, Innenbearbeitung

Doppelklemmhalter für passende Langdrehautomaten.

Toolholder, Internal Applications

Double toolholder for swiss type machines.

Anzugsmoment (Schraube) // Tightening torque (screw)

7,0 Nm

Bitte Hinweise im Anhang beachten // Please read add. notes

MASTER (Seite/Page 137)



TW Legende
ST Legend

139

Scan QR-Code

Oder besuchen Sie // Or Visit
www.simtek.info/cp/742

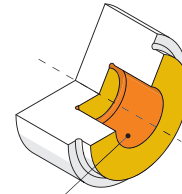
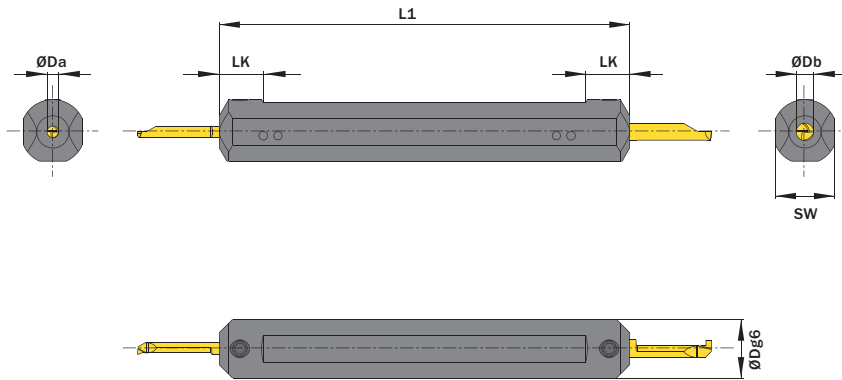

- Hauptsächlich geeignet für diese Flächen
Mainly designed for these surfaces
- Je nach Schneidplatte ebenfalls möglich
Also possible depending on insert type

Abbildung zeigt / Drawing shows: A04.0.750.0140.A06

| ØDa | ØDg6 | L1 | ØDb | Artikelnummer Part number | Webcode www.simtek.com/webcode | LK | SW | Schraube Screw | Schraubenschlüssel Screw driver | Connectcode www.simtek.com/code |
|-----------------------|-------|-------|-----|------------------------------|-----------------------------------|------|------|-------------------|------------------------------------|--|
| mm | mm | mm | mm | | | mm | mm | | | |
| ▼ ØDa = 4,0 mm | | | | | | | | | | |
| 4,0 | 19,05 | 140,0 | 6,0 | A04.0.750.0140.A06 | AHWS | 15,0 | 17,0 | A M6x7,5 T15F | T15F | A04.L A04.R A04CL A04.C.R A06.L A06.R |
| 4,0 | 20,0 | 140,0 | 4,0 | A04.0020.0140.A04 | APJQ | 15,0 | 17,0 | A M6x7,5 T15F | T15F | A04.L A04.R A04CL A04C.R |
| 4,0 | 20,0 | 140,0 | 5,0 | A04.0020.0140.A05 | AMF0 | 15,0 | 17,0 | A M6x7,5 T15F | T15F | A04.L A04.R A04CL A04.C.R A05.L A05.R |
| 4,0 | 20,0 | 140,0 | 6,0 | A04.0020.0140.A06 | AAWT | 15,0 | 18,0 | A M6x7,5 T15F | T15F | A04.L A04.R A04CL A04.C.R A06.L A06.R |
| 4,0 | 22,0 | 140,0 | 4,0 | A04.0022.0140.A04 | AGV1 | 15,0 | 20,0 | A M6x7,5 T15F | T15F | A04.L A04.R A04CL A04C.R |
| 4,0 | 22,0 | 140,0 | 6,0 | A04.0022.0140.A06 | AA6P | 15,0 | 20,0 | A M6x7,5 T15F | T15F | A04.L A04.R A04CL A04.C.R A06.L A06.R |
| 4,0 | 25,0 | 140,0 | 6,0 | A04.0025.0140.A06 | AEZP | 15,0 | 23,0 | A M6x7,5 T15F | T15F | A04.L A04.R A04CL A04.C.R A06.L A06.R |
| 4,0 | 28,0 | 140,0 | 6,0 | A04.0028.0140.A06 | AB7A | 15,0 | 26,0 | A M6x7,5 T15F | T15F | A04.L A04.R A04CL A04.C.R A06.L A06.R |
| ▼ ØDa = 5,0 mm | | | | | | | | | | |
| 5,0 | 20,0 | 140,0 | 5,0 | A05.0020.0140.A05 | AK9Y | 15,0 | 17,0 | A M6x7,5 T15F | T15F | A05.L A05.R |
| 5,0 | 20,0 | 140,0 | 6,0 | A05.0020.0140.A06 | APND | 15,0 | 17,0 | A M6x7,5 T15F | T15F | A05.L A05.R A06.L A06.R |
| ▼ ØDa = 6,0 mm | | | | | | | | | | |
| 6,0 | 20,0 | 140,0 | 6,0 | A06.0020.0140.A06 | AGXT | 15,0 | 17,0 | A M6x7,5 T15F | T15F | A06.L A06.R |
| 6,0 | 22,0 | 140,0 | 6,0 | A06.0022.0140.A06 | AJC6 | 15,0 | 19,0 | A M6x7,5 T15F | T15F | A06.L A06.R |

Bestellbeispiel // Order example: **A04.0022.0140.A06**