

Klemmhalter, Innenbearbeitung

Stahl-Rundschaft mit innerer Kühlmittelzufuhr.

Toolholder, For Internal Applications

Steel round shank toolholder with through coolant.

Anzugsmoment (Schraube) // Tightening torque (screw)

"D M2,6x8 T8F": 1,5 Nm
 "D M3,5x10 T10F": 3,0 Nm
 "D M5x12 T20T": 7,0 Nm

Bitte Hinweise im Anhang beachten // Please read add. notes

MASTER (Seite/Page 212)



Legende
Legend **213**

Scan QR-Code

Oder besuchen Sie // Or Visit
www.simtek.info/cp/811

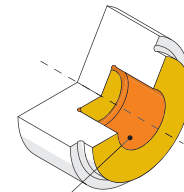
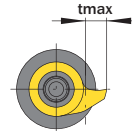
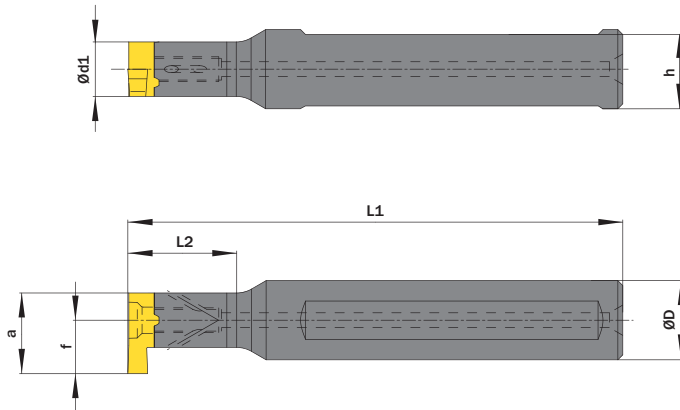

Maße „a“, „f“ und „tmax“ sind abhängig vom verwendeten Schneideinsatz.
 Dimensions „a“, „f“ and „tmax“ depend on used carbide inserts.

Abbildung zeigt / Drawing shows: D16.0016.22 ST

- Hauptsächlich geeignet für diese Flächen
Mainly designed for these surfaces
- Je nach Schneidplatte ebenfalls möglich
Also possible depending on insert type

ØD ^{g6}	L2	Artikelnummer Part number	Webcode www.simtek.com/webcode	Ød1	h	L1	Schraube Screw	Schraubenschlüssel Screw driver	Connectcode www.simtek.com/code
mm	mm			mm	mm	mm			
▼ Connectcode = D08									
12,0	21,0	D08.0012.21 ST	AKHT	6,0	11,0	80,0	D M2,6x8 T8F	T8F	D08
16,0	12,0	D08.0016.12 ST	AH2A	6,0	15,0	80,0	D M2,6x8 T8F	T8F	D08
12,7	12,0	D08.0.500.12 ST	A22H	6,0	12,2	80,0	D M2,6x8 T8F	T8F	D08 <small>Inch</small>
15,875	12,0	D08.0.625.12 ST	ABT9	6,0	14,88	80,0	D M2,6x8 T8F	T8F	D08 <small>Inch</small>
▼ Connectcode = D11									
12,0	29,0	D11.0012.29 ST	AAV0	8,0	11,0	95,0	D M3,5x10 T10F	T10F	D11
16,0	16,0	D11.0016.16 ST	ANMK	8,0	15,0	97,0	D M3,5x10 T10F	T10F	D11
15,875	16,0	D11.0.625.16 ST	AGFE	8,0	14,88	97,0	D M3,5x10 T10F	T10F	D11 <small>Inch</small>
▼ Connectcode = D16									
16,0	22,0	D16.0016.22 ST	AEQC	11,0	15,0	100,0	D M5x12 T20T	T20T	D16
15,875	22,0	D16.0.625.22 ST	ADXJ	11,0	14,88	100,0	D M5x12 T20T	T20T	D16 <small>Inch</small>

Bestellbeispiel // Order example: **D16.0016.22 ST**