

Doppelklemmhalter, Innenbearbeitung

Doppelklemmhalter für passende Langdrehautomaten.

Toolholder, Internal Applications

Double toolholder for swiss type machines.

Anzugsmoment (Schraube) // Tightening torque (screw)

7,0 Nm

Bitte Hinweise im Anhang beachten // Please read add. notes

MASTER (Seite/Page 137)



TW Legende
ST Legend

139



Scan QR-Code

Oder besuchen Sie // Or Visit
www.simtek.info/cp/742

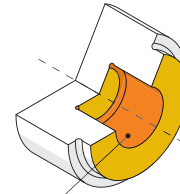
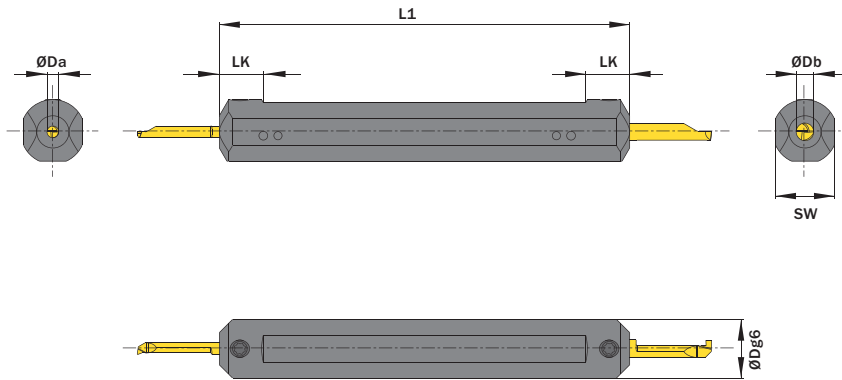

- Hauptsächlich geeignet für diese Flächen
Mainly designed for these surfaces
- Je nach Schneidplatte ebenfalls möglich
Also possible depending on insert type

Abbildung zeigt / Drawing shows: A04.0.750.0140.A06

ØDa	ØDg6	L1	ØDb	Artikelnummer Part number	Webcode www.simtek.com/webcode	LK	SW	Schraube Screw	Schraubenschlüssel Screw driver	Connectcode www.simtek.com/code
mm	mm	mm	mm			mm	mm			
▼ ØDa = 4,0 mm										
4,0	19,05	140,0	6,0	A04.0.750.0140.A06	AHWS	15,0	17,0	A M6x7,5 T15F	T15F	A04.L A04.R A04CL A04.C.R A06.L A06.R
4,0	20,0	140,0	4,0	A04.0020.0140.A04	APJQ	15,0	17,0	A M6x7,5 T15F	T15F	A04.L A04.R A04CL A04C.R
4,0	20,0	140,0	5,0	A04.0020.0140.A05	AMF0	15,0	17,0	A M6x7,5 T15F	T15F	A04.L A04.R A04CL A04.C.R A05.L A05.R
4,0	20,0	140,0	6,0	A04.0020.0140.A06	AAWT	15,0	18,0	A M6x7,5 T15F	T15F	A04.L A04.R A04CL A04.C.R A06.L A06.R
4,0	22,0	140,0	4,0	A04.0022.0140.A04	AGV1	15,0	20,0	A M6x7,5 T15F	T15F	A04.L A04.R A04CL A04C.R
4,0	22,0	140,0	6,0	A04.0022.0140.A06	AA6P	15,0	20,0	A M6x7,5 T15F	T15F	A04.L A04.R A04CL A04.C.R A06.L A06.R
4,0	25,0	140,0	6,0	A04.0025.0140.A06	AEZP	15,0	23,0	A M6x7,5 T15F	T15F	A04.L A04.R A04CL A04.C.R A06.L A06.R
4,0	28,0	140,0	6,0	A04.0028.0140.A06	AB7A	15,0	26,0	A M6x7,5 T15F	T15F	A04.L A04.R A04CL A04.C.R A06.L A06.R
▼ ØDa = 5,0 mm										
5,0	20,0	140,0	5,0	A05.0020.0140.A05	AK9Y	15,0	17,0	A M6x7,5 T15F	T15F	A05.L A05.R
5,0	20,0	140,0	6,0	A05.0020.0140.A06	APND	15,0	17,0	A M6x7,5 T15F	T15F	A05.L A05.R A06.L A06.R
▼ ØDa = 6,0 mm										
6,0	20,0	140,0	6,0	A06.0020.0140.A06	AGXT	15,0	17,0	A M6x7,5 T15F	T15F	A06.L A06.R
6,0	22,0	140,0	6,0	A06.0022.0140.A06	AJC6	15,0	19,0	A M6x7,5 T15F	T15F	A06.L A06.R

Bestellbeispiel // Order example: **A04.0022.0140.A06**