

# Klemmhalter, Innenbearbeitung, Gekröpft

Gekröpfte Ausführung für passende Langdrehautomaten und Mehrspindler.

# Toolholder, Internal Applications, Cranked

Cranked toolholder for swiss type machines.

Anzugsmoment (Schraube) // Tightening torque (screw)

**7,0 Nm**

Bitte Hinweise im Anhang beachten // Please read add. notes

**MASTER (Seite/Page 137)**



Legende  
Legend **139**



Oder besuchen Sie // Or Visit  
[www.simtek.info/cp/744](http://www.simtek.info/cp/744)

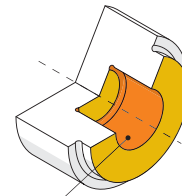
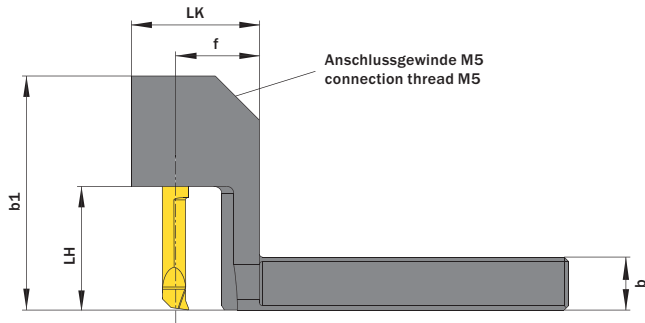
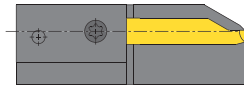
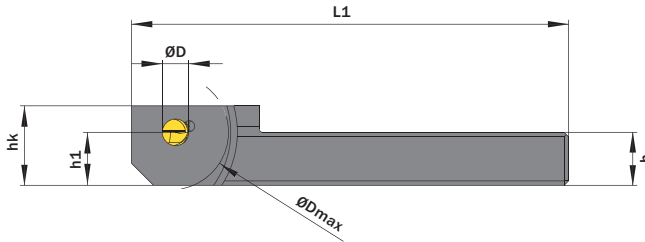

- Hauptsächlich geeignet für diese Flächen  
Mainly designed for these surfaces
- Je nach Schneidplatte ebenfalls möglich  
Also possible depending on insert type

ØD	h	b	Artikelnummer Part number	Webcode www.simtek.com/webcode	b1	ØDmax	f	hk	h1	L1	LK	LH	Schraube Screw	Schraubenschlüssel Screw driver	Connectcode www.simtek.com/code
mm	mm	mm			mm	mm	mm	mm	mm	mm	mm	mm			
4,0	9,525	9,525	<b>A04.0.375.10 R/L</b>	R A5U3 L A5U5	36,5	26,0	19,0	16,0	9,52	99,0	29,0	13,0	A M6x7,5 T15F	T15F	R A04.R A04C.R L A04.L A04C.L <span style="float: right;">new inch</span>
4,0	9,525	9,525	<b>A04.0.375.15 R/L</b>	R AC1Z L AMDE	36,5	26,0	19,0	16,0	9,52	99,0	29,0	18,0	A M6x7,5 T15F	T15F	R A04.R A04C.R L A04.L A04C.L <span style="float: right;">inch</span>
4,0	12,7	12,7	<b>A04.0.500.10 R</b>	A235	31,5	26,0	19,0	19,0	12,7	99,0	29,0	13,0	A M6x7,5 T15F	T15F	A04.R A04C.R <span style="float: right;">new inch</span>
4,0	12,7	12,7	<b>A04.0.500.15 R/L</b>	R AB49 L AD3A	36,5	26,0	19,0	19,0	12,7	99,0	29,0	18,0	A M6x7,5 T15F	T15F	R A04.R A04C.R L A04.L A04C.L <span style="float: right;">inch</span>
4,0	8,0	8,0	<b>A04.0808.10 R/L</b>	R APYN L AA2M	31,5	26,0	19,0	14,0	8,0	99,0	29,0	13,0	A M6x7,5 T15F	T15F	R A04.R A04C.R L A04.L A04C.L
4,0	8,0	8,0	<b>A04.0808.15 R/L</b>	R AF3M L AKCJ	36,5	26,0	19,0	14,0	8,0	99,0	29,0	18,0	A M6x7,5 T15F	T15F	R A04.R A04C.R L A04.L A04C.L
4,0	10,0	10,0	<b>A04.1010.10 R/L</b>	R ANAT L AEØP	31,5	26,0	19,0	16,0	10,0	99,0	29,0	13,0	A M6x7,5 T15F	T15F	R A04.R A04C.R L A04.L A04C.L
4,0	10,0	10,0	<b>A04.1010.15 R/L</b>	R AF2T L AAX5	36,5	26,0	19,0	16,0	10,0	99,0	29,0	18,0	A M6x7,5 T15F	T15F	R A04.R A04C.R L A04.L A04C.L
4,0	12,0	12,0	<b>A04.1212.10 R/L</b>	R AHFU L ANE7	31,5	26,0	19,0	18,0	12,0	99,0	29,0	13,0	A M6x7,5 T15F	T15F	R A04.R A04C.R L A04.L A04C.L
4,0	12,0	12,0	<b>A04.1212.15 R/L</b>	R AFNB L AEEP	36,5	26,0	19,0	18,0	12,0	99,0	29,0	18,0	A M6x7,5 T15F	T15F	R A04.R A04C.R L A04.L A04C.L
4,0	16,0	16,0	<b>A04.1616.15 R/L</b>	R ABWP L AHM3	36,5	36,0	24,0	22,0	16,0	104,0	34,0	18,0	A M6x7,5 T15F	T15F	R A04.R A04C.R L A04.L A04C.L

Verwandte Werkzeuge finden Sie auch auf der folgenden Seite!  
Related Items can be found on the following page as well!

Fortgesetzte Tabelle  
Continued Table

Bestellbeispiel // Order example: **A04.1616.15 R** (R = Rechte Ausführung // Right hand version)