

# Abstechen

Verfügbar in verschiedenen Breiten und Winkeln.  
 Gesinterte Spanformgeometrie für kontrollierte Spanbildung.

# Parting Off

Available in different widths and angles.  
 Sintered geometry for improved chip control.

Schnittwerte (Start) // Cutting parameters (start)	
f (außen//ext.) 0,12 mm/U	Vc Seite/Page 442

Passende Klemmhalter auf Seite // Suitable toolholders on page  
 307, 308, 309, 310, 311, 312, 313, 314, 315

SP

HM

R

Legende  
Legend **327**

Scan QR-Code Oder besuchen Sie // Or Visit  
[www.simtek.info/cp/526](http://www.simtek.info/cp/526)

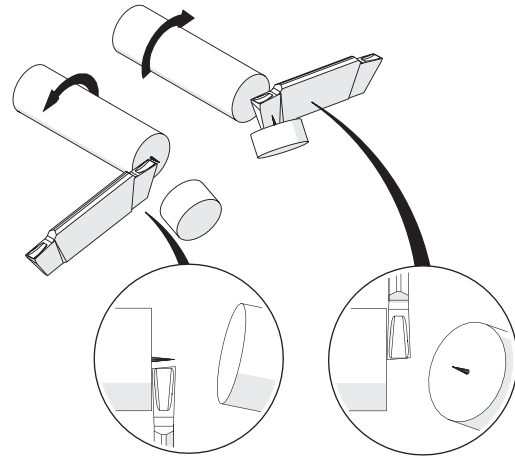
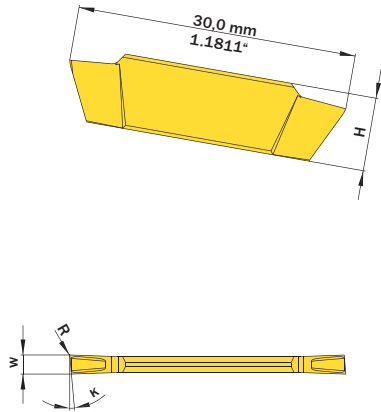

Abbildung zeigt / Drawing shows: G29.5200.32 S R

K	w <sup>+0,05</sup> mm	Artikelnummer Part number	Webcode www.simtek.com/webcode	Empfohlene Schneidstoffe Recommended cutting grades						H mm	R mm	Connectcode www.simtek.com/ccode
				P	K	M	N	S	H			
▼ w = 2,0 mm												
15°	2,0	<b>G29.1520.32 S R/L</b>	R AMF7 L ANHX	X800	X400 X600	GX79	X500	X400	7,9	0,2	G29.02	
5°	2,0	<b>G29.5200.32 S R/L</b>	R AMW7 L AGQ9	X800	X400 X600	GX79	X500	X400	7,9	0,2	G29.02	
8°	2,0	<b>G29.8200.32 S R/L</b>	R AAKB L AFZF	X800	X400 X600	GX79	X500	X400	7,9	0,2	G29.02	
▼ w = 2,5 mm												
5°	2,5	<b>G29.5250.32 S R/L</b>	R AATN L AHAD	X800	X400 X600	GX79	X500	X400	7,9	0,2	G29.02	
▼ w = 3,0 mm												
15°	3,0	<b>G29.1530.32 S R/L</b>	R A5CF L AATT	X800	X400 X600	GX79	X500	X400	7,9	0,2	G29.03	
5°	3,0	<b>G29.5300.32 S R/L</b>	R AH07 L ABKE	X800	X400 X600	GX79	X500	X400	7,9	0,2	G29.03	
8°	3,0	<b>G29.8300.32 S R/L</b>	R AA90 L AM09	X800	X400 X600	GX79	X500	X400	7,9	0,2	G29.03	
▼ w = 4,0 mm												
5°	4,0	<b>G29.5400.32 S R/L</b>	R AB5F L AFQH	X800	X400 X600	GX79	X500	X400	7,9	0,2	G29.03   G29.04	

Bestellbeispiel // Order example: **G29.5300.32 S R X800** (R = Rechte Ausführung // Right hand version, X800 = Schneidstoff // Grade)

simturn AX  
simturn DX  
simturn PX  
simturn H2  
simturn K2  
simturn GX  
simturn E3  
simturn E12  
simturn FX  
simturn Decolletage  
simturn OA  
Index