

# Klemmhalter, Innenbearbeitung, Quadratschaft

90 Grad gekrüpfte Ausführung.

## Toolholder, Internal Applications, Square Shank

90 degree cranked style.

Anzugsmoment (Schraube) // Tightening torque (screw)

**7,0 Nm**

Bitte Hinweise im Anhang beachten // Please read add. notes

**MASTER (Seite/Page 137)**



Legende  
Legend **139**



Scan  
QR-Code

Oder besuchen Sie // Or Visit  
[www.simtek.info/cp/1026](http://www.simtek.info/cp/1026)

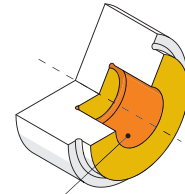
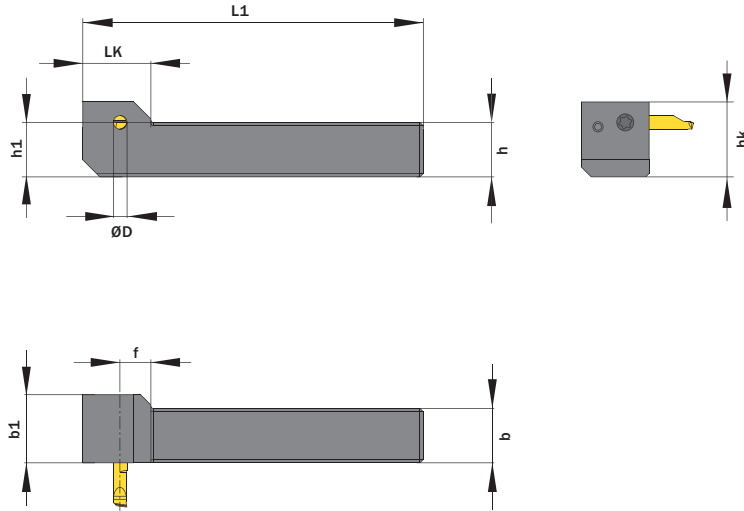

- Hauptsächlich geeignet für diese Flächen  
Mainly designed for these surfaces
- Je nach Schneidplatte ebenfalls möglich  
Also possible depending on insert type

Abbildung zeigt / Drawing shows: A04.1616.G.100 R

ØD	h	b	L1	Artikelnummer Part number	Webcode www.simtek.com/webcode	b1	f	hk	h1	LK	Schraube Screw	Schraubenschlüssel Screw driver	Connectcode www.simtek.com/code
mm	mm	mm	mm			mm	mm	mm	mm	mm			
▼ ØD = 4,0 mm													
4,0	12,0	12,0	80,0	<b>A04.1212.G.080 R/L</b>	R AW2V L AW2U	20,0	9,0	18,0	12,0	20,0	AM6x7,5 T15F	T15F	R A04.R   A04C.R L A04.L   A04C.L
4,0	16,0	16,0	100,0	<b>A04.1616.G.100 R/L</b>	R AW4E L AW2W	20,0	9,0	22,0	16,0	20,0	AM6x7,5 T15F	T15F	R A04.R   A04C.R L A04.L   A04C.L
▼ ØD = 5,0 mm													
5,0	12,7	12,7	80,0	<b>A05.0.500.G.080 R</b>	A5AV	25,0	9,0	18,0	12,7	20,0	AM6x7,5 T15F	T15F	<b>A05.R</b>
5,0	15,875	15,875	100,0	<b>A05.0.625.G.100 R</b>	A5AX	25,0	9,0	22,0	15,9	20,0	AM6x7,5 T15F	T15F	<b>A05.R</b>
5,0	12,0	12,0	80,0	<b>A05.1212.G.080 R/L</b>	R AW2Y L AW2X	25,0	9,0	18,0	12,0	20,0	AM6x7,5 T15F	T15F	R A05.R L A05.L
5,0	16,0	16,0	100,0	<b>A05.1616.G.100 R/L</b>	R AW2Ø L AW2Z	25,0	9,0	22,0	16,0	20,0	AM6x7,5 T15F	T15F	R A05.R L A05.L
▼ ØD = 6,0 mm													
6,0	12,0	12,0	80,0	<b>A06.1212.G.080 R/L</b>	R AW22 L AW21	25,0	9,0	18,0	12,0	20,0	AM6x7,5 T15F	T15F	R A06.R L A06.L
6,0	16,0	16,0	100,0	<b>A06.1616.G.100 R/L</b>	R AW24 L AW23	25,0	9,0	22,0	16,0	20,0	AM6x7,5 T15F	T15F	R A06.R L A06.L
▼ ØD = 7,0 mm													
7,0	12,0	12,0	80,0	<b>A07.1212.G.080 R/L</b>	R AW26 L AW25	25,0	9,0	18,0	12,0	20,0	AM6x7,5 T15F	T15F	R A07.R L A07.L
7,0	16,0	16,0	100,0	<b>A07.1616.G.100 R/L</b>	R AW28 L AW27	25,0	9,0	22,0	16,0	20,0	AM6x7,5 T15F	T15F	R A07.R L A07.L

Bestellbeispiel // Order example: **A04.1616.G.100 R** (R = Rechte Ausführung // Right hand version)